



1. Room Locations
2. AV Technologies
3. Faculty Resources



The new **ILSB** will provide:

- **active-learning classrooms, seminar rooms, and teaching labs** in support of UMBC's science, technology, engineering, and mathematics programs;
 - ❖ **4 – 90 seat active learning classrooms** (2 classrooms can be combined into one 180 seat classroom)
 - ❖ **Fixed 6 seat tables**
 - ❖ **4 – 48 seat active learning classrooms**
 - ❖ **Fixed 4 seat tables**
 - ❖ **4 – 24 seat seminar rooms**
 - ❖ **Moveable tables and chairs**
 - ❖ **4 – 24 seat teaching laboratories**
 - ❖ **Lab seating**





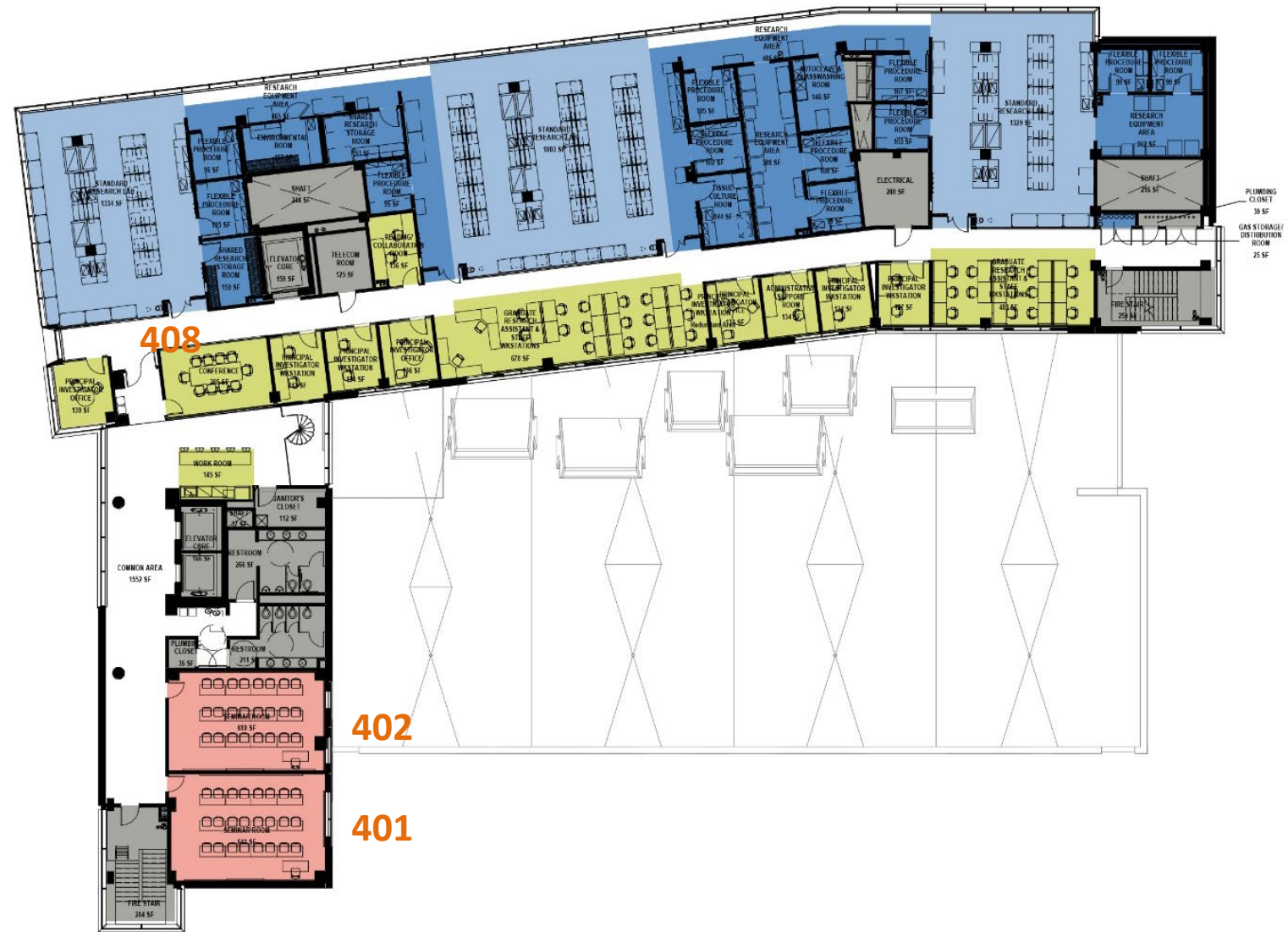

90-Person Active Learning Classroom (2,400 SF)



PERSPECTIVE VIEW

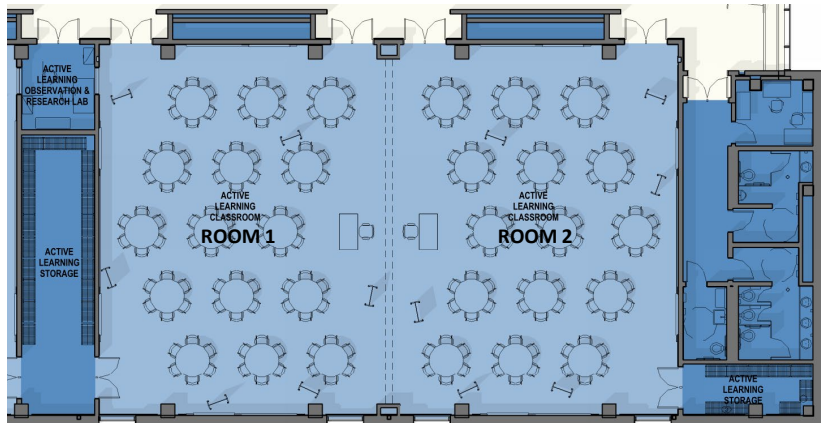

PLAN VIEW – DOUBLE ROOM WITH OPERABLE PARTITION SHOWN

A/V & CONNECTIVITY

- FOUR 80”-DIAGONAL LCD MONITORS ON TILT-ARM DISTRIBUTED THROUGHOUT CLASSROOM
- CEILING-MOUNTED SPEAKERS DISTRIBUTED THROUGHOUT
- ALL INTERNET IS CONNECTED VIA WIFI – POWER PORTS WITH USB AT STUDENT TABLES
- POWER & DATA CONNECTIONS AT LECTURN
- ALL A/V EQUIPMENT IS HOUSED WITHIN AND ACCESSED FROM LECTURN
 - Intuitive touch panel AV control
 - All-in-one PC
 - Wireless microphone
 - Solstice Wireless Collaboration
 - Document Camera
 - HDMI laptop cable
 - Assistive listening receivers

FURNITURE



42” CENTER PEDESTAL TABLE W/ POWER – PLAM FINISH (6 STUDENTS)



STUDENT CHAIRS W/ ARMS



MOBILE MARKER BOARDS



POWER CONNECTIVITY (ONE OUTLET PER STUDENT)

48-Person Active Learning Classroom (1,280 SF)



PERSPECTIVE VIEW

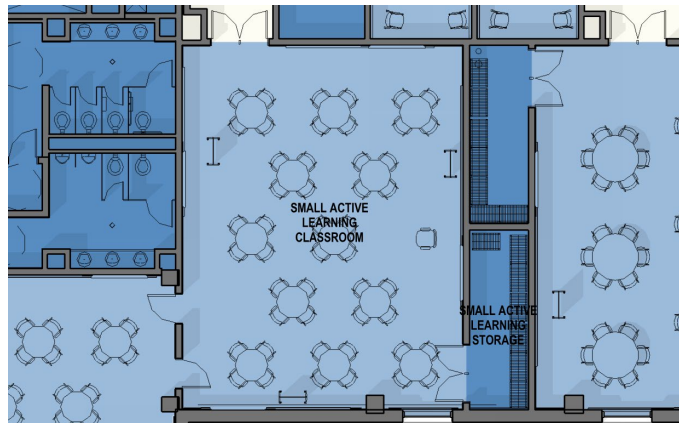

PLAN VIEW

A/V & CONNECTIVITY

- FOUR 80"-DIAGONAL LCD MONITORS ON TILT-ARM DISTRIBUTED THROUGHOUT CLASSROOM
- CEILING-MOUNTED SPEAKERS DISTRIBUTED THROUGHOUT
- ALL INTERNET IS CONNECTED VIA WIFI – POWER PORTS WITH USB AT STUDENT TABLES
- POWER & DATA CONNECTIONS AT LECTURN
- ALL A/V EQUIPMENT IS HOUSED WITHIN AND ACCESSED FROM LECTURN
 - Intuitive touch panel AV control
 - Wireless microphone
 - Solstice Wireless Collaboration
 - Document Camera
 - HDMI laptop cable
 - Assistive listening receivers

FURNITURE



42" CENTER PEDESTAL TABLE W/ POWER – PLAM FINISH (4 STUDENTS)



MOBILE MARKER BOARDS



POWER CONNECTIVITY (ONE OUTLET PER STUDENT)

24-Person Seminar Room (600 SF)

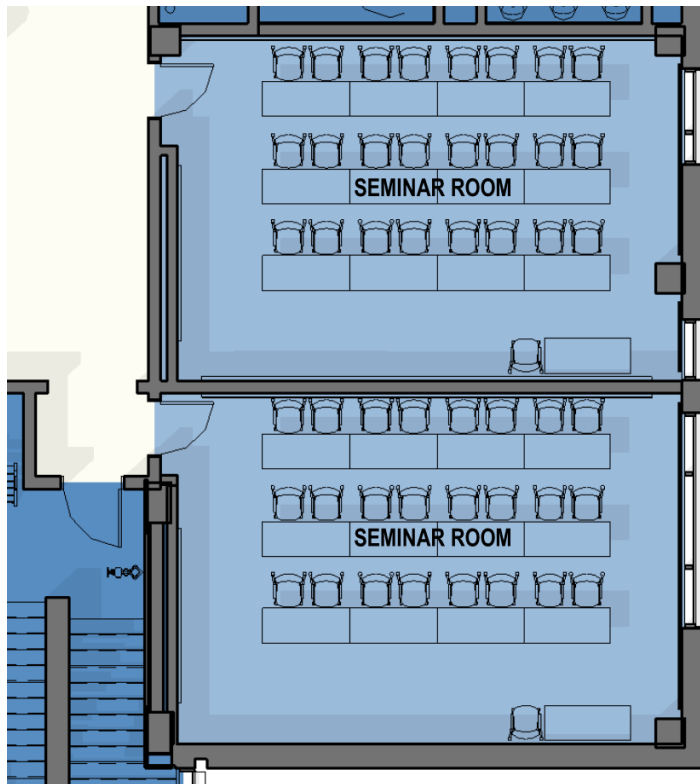

PLAN VIEW

A/V & CONNECTIVITY

- ONE CEILING-MOUNTED VIDEO PROJECTION SCREEN WITH 57.5”H X 92”W VIEWING AREA
- CEILING-MOUNTED SPEAKERS DISTRIBUTED THROUGHOUT
- ALL INTERNET IS CONNECTED VIA WIFI – NO DATA PORTS
- POWER WITH USB IS PROVIDED TO STUDENTS VIA OUTLETS IN FLOORBOXES
- POWER & DATA CONNECTIONS AT LECTURN
- ALL A/V EQUIPMENT IS HOUSED WITHIN AND ACCESSED FROM LECTURN
 - Intuitive push button AV control
 - Wireless microphone
 - Solstice Wireless Collaboration
 - Document Camera
 - HDMI laptop cable
 - Assistive listening receivers

FURNITURE



24” X 60” FLIP TOP TRAINING TABLES



STUDENT CHAIRS NESTING



POWER CONNECTIVITY – FLOOR BOXES W/ OUTLETS

24-Person Teaching Lab (1,300 SF)

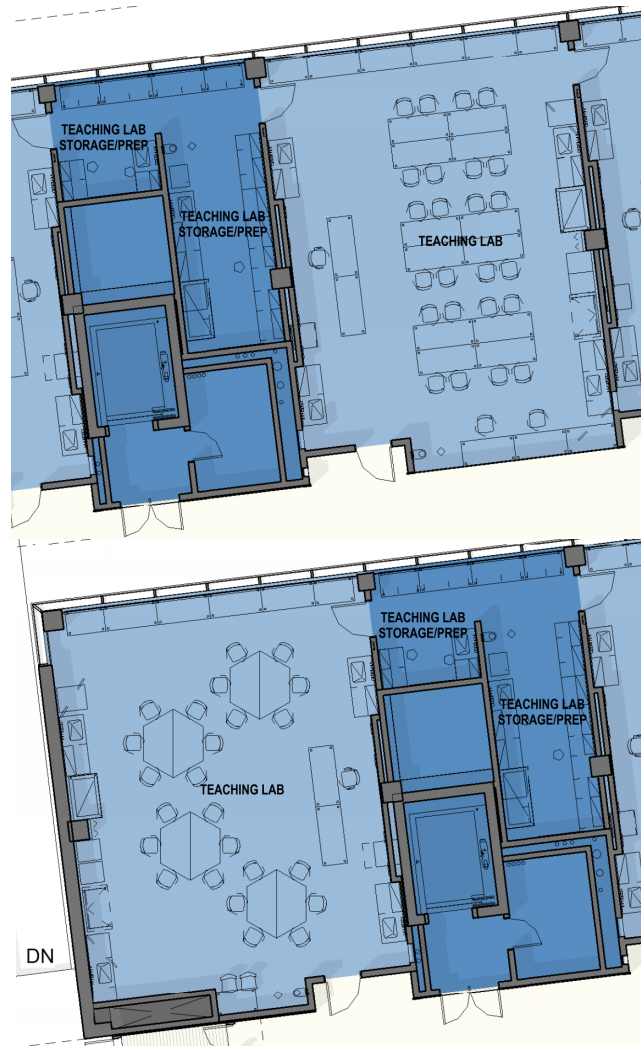

A/V & CONNECTIVITY

- FOUR 65"-DIAGONAL LCD MONITORS ON DISTRIBUTED THROUGHOUT CLASSROOM
- CEILING-MOUNTED SPEAKERS DISTRIBUTED THROUGHOUT
- ALL INTERNET IS CONNECTED VIA WIFI – POWER WITH USB PORTS AT STUDENT TABLES
- POWER & DATA CONNECTIONS AT INSTRUCTOR’S STATION
- ALL A/V EQUIPMENT IS CONCEALED WITHIN CABINET BELOW INSTRUCTOR’S STATION
 - Intuitive touch panel AV control
 - Wireless microphone
 - Solstice Wireless Collaboration
 - Document Camera
 - HDMI laptop cable
 - Assistive listening receivers

FURNITURE



ADJUSTABLE-HEIGHT
HEXAGONAL LAB BENCHES
(6 STUDENTS)



STUDENT STOOLS
W/ ARMS



POWER CONNECTIVITY
(ONE OUTLET PER STUDENT)

10:13 | Tuesday 13 August 2019

Room Name : 130.85.xxx.xx

Code : XXXX

**First time using VIA?**

- 1 Connect to the Room Wi-Fi
- 2 Enter the 'Room Name' into your Internet Browser

Look for the VIA app:Available in the
CHROME WEB STOREDownload it from
APP STOREAirplay is available
for iOS devicesDownload it from
GOOGLE PLAYDownload it from
WINDOWS STORE**XXXX**

- Use the Kramer VIA to wirelessly connect your device to the display
- Device agnostic – connect Windows and Mac laptops, Chromebooks, iOS, Airplay, and Android
- Use Visitor, Campus, or Eduroam WiFi networks
- Download and install the Kramer VIA application on your device
- Using the app
 - Enter the Room Name (130.85.xx.xx) and Code
 - Follow directions on your screen
 - Log off when done
- Display more than one device on the screen at the same time
- For presentations, documents, web
 - **Not** for full motion video nor videoconferencing

The FDC is happy to help you think through course design to take advantage of an active learning classroom. To schedule a consultation, email fdc@umbc.edu. The following resources are also helpful as you adapt to an active learning classroom:

- Collect and synthesize student midterm feedback with our **CATALyst process**
- Get personalized support from **classroom observations** based on your questions
- Tackle teaching issues and questions in an **individual consultation**
- Obtain support for **pedagogical innovation and research**
- Design effective **learning assessment** processes and tools
- Borrow the latest titles in teaching and learning from our **lending library**
- Cultivate student success by participating in our **certificate programs**
- Explore evidence-based teaching in an interdisciplinary **Faculty Learning Community**
- Write a compelling **Hrabowski Innovation Grant** proposal
- Find **web resources** on teaching and learning including this paper on group work
<https://bit.ly/2YUh3WO>

We are here to support you in your teaching role at UMBC!

All midterm feedback, class observations, and consultation services are confidential and are not used by administrators or committees in making personnel decisions.

Ready to learn more?

Visit us at fdc.umbc.edu or Engineering 101

Join the FDC myUMBC group: my.umbc.edu/groups/fdc

Request to join the FDC email list: <https://bit.ly/2MhroqX>

Have a question or suggestion for an upcoming program?

Contact us at fdc@umbc.edu or (410) 455-3916